

ID: 0050253

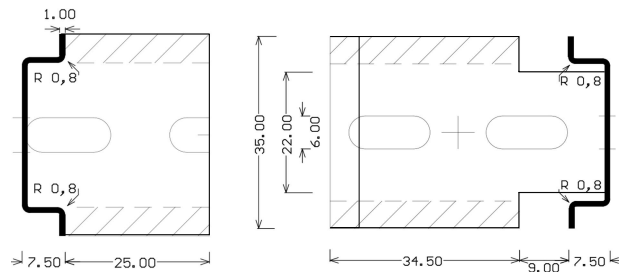

Dimension in mm

Technical Data	
Din Rail type	35 / 7.5
Height x Width x Length	L-Shape
Test standard	In acc. With EN 60715
Electroplated coating	Fe//Zn12//C
Zinc layer thickness	8~12 um
Colour appearance	Iridescence
Weight	Approx 15gm
Model: DLA	